

# HOLIDAY COVE RV RESORT CORTEZ, FLORIDA

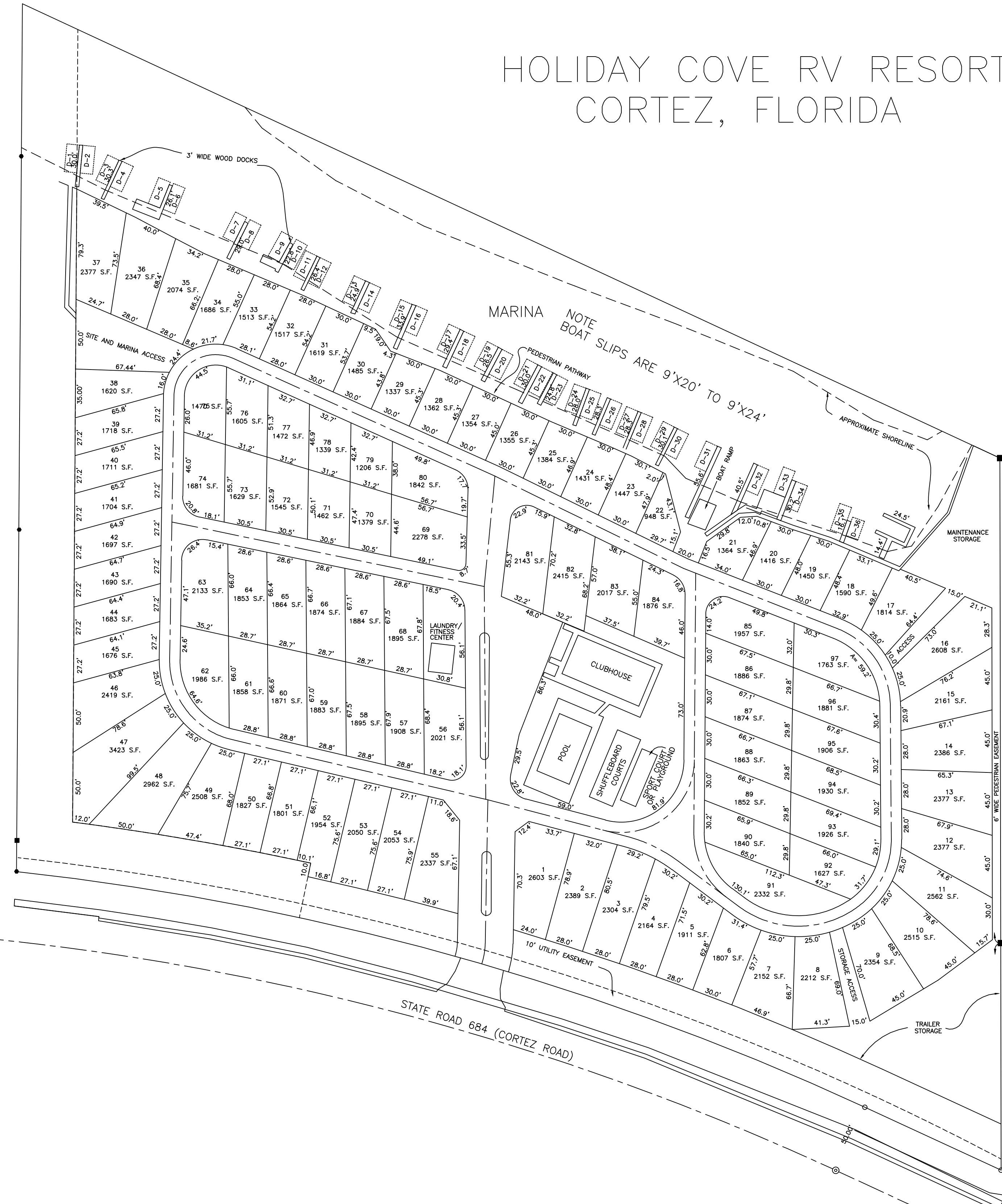

**CYRIX ENGINEERING, INC.**  
Engineers & Surveyors  
7678 15th Street East  
Sarasota, FL 34243  
(941) 358-8812 (ph) \* (941) 358-8909 (fax)

PROJECT NO. 182-280	DRAWN BY: K.E.P.	FB	Pg. 1
CHECKED BY: J.E.P.	DWG. DATE	SURVEY DATE	DATE
REVISIONS			
LOT 10-37	12-19-07	K.E.P.	BY
LOT 8-16 AND LOTS 35-45	01-03-08	K.E.P.	DATE
LOT 38	04-21-08	K.E.P.	BY
LOT 39	05-27-08	K.E.P.	DATE

PRELIMINARY PLAT LAYOUT  
HOLIDAY COVE RV PARK  
SUBJECT LAND LYING IN SECTION 3, TOWNSHIP 35 SOUTH, RANGE 16 EAST, MANATEE COUNTY, FLORIDA.